



# basic education

Department:  
Basic Education  
**REPUBLIC OF SOUTH AFRICA**

**NATIONAL  
SENIOR CERTIFICATE**

**GRADE 12**

**MATHEMATICAL LITERACY P1**

**ADDENDUM**

**FEBRUARY/MARCH 2018**

**This addendum consists of 4 pages with 3 annexures.**

**ANNEXURE A**  
**QUESTION 3.1**

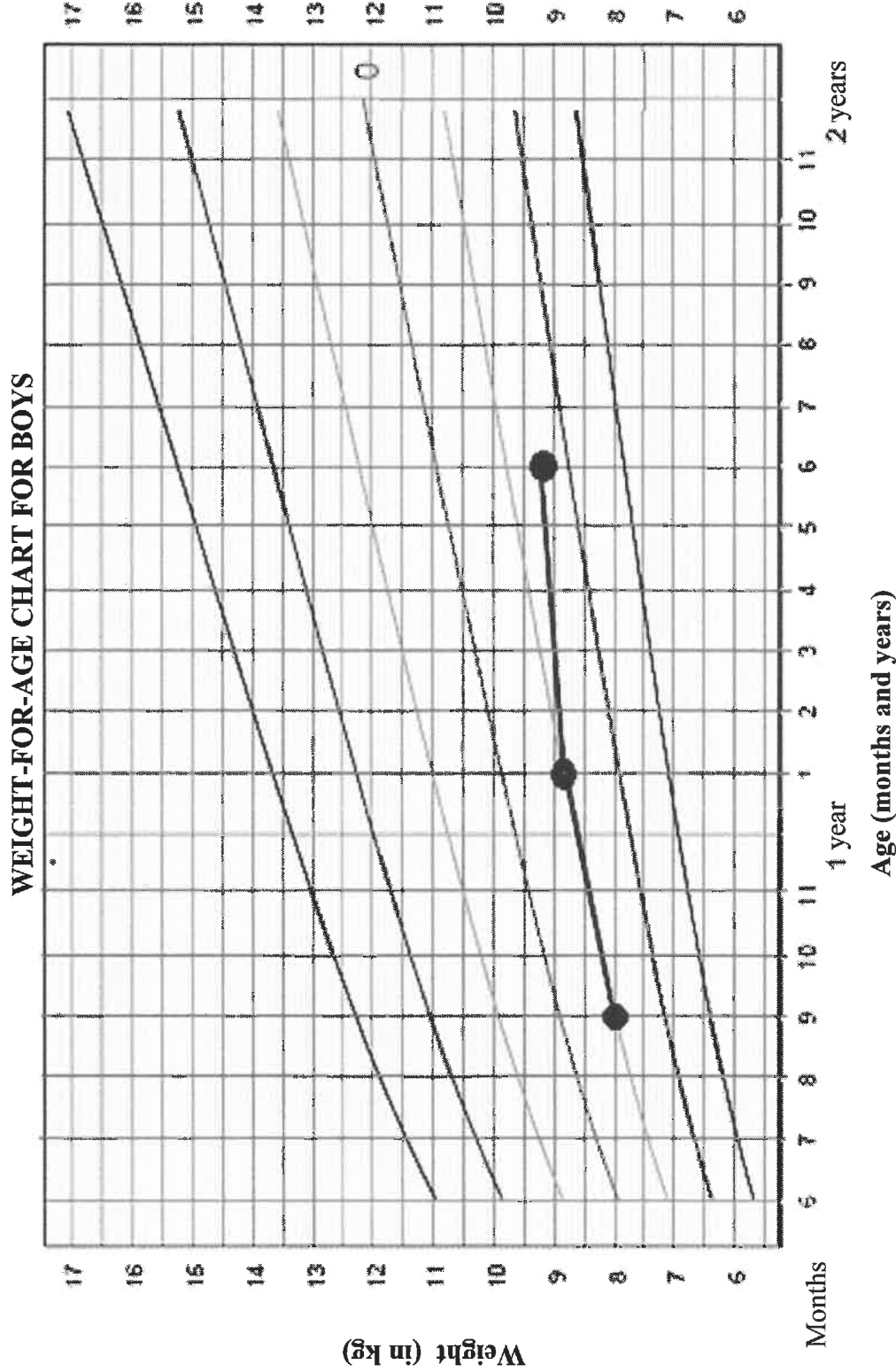

**NOTE:** The dots on the solid black line shows the three visits.

[Source: World Health Organisation (WHO)]

ANNEXURE B

QUESTION 4.1

STRIP CHART OF THE ROUTE FROM COLESBERG TO PORT ELIZABETH (DISTANCES IN KILOMETRES)

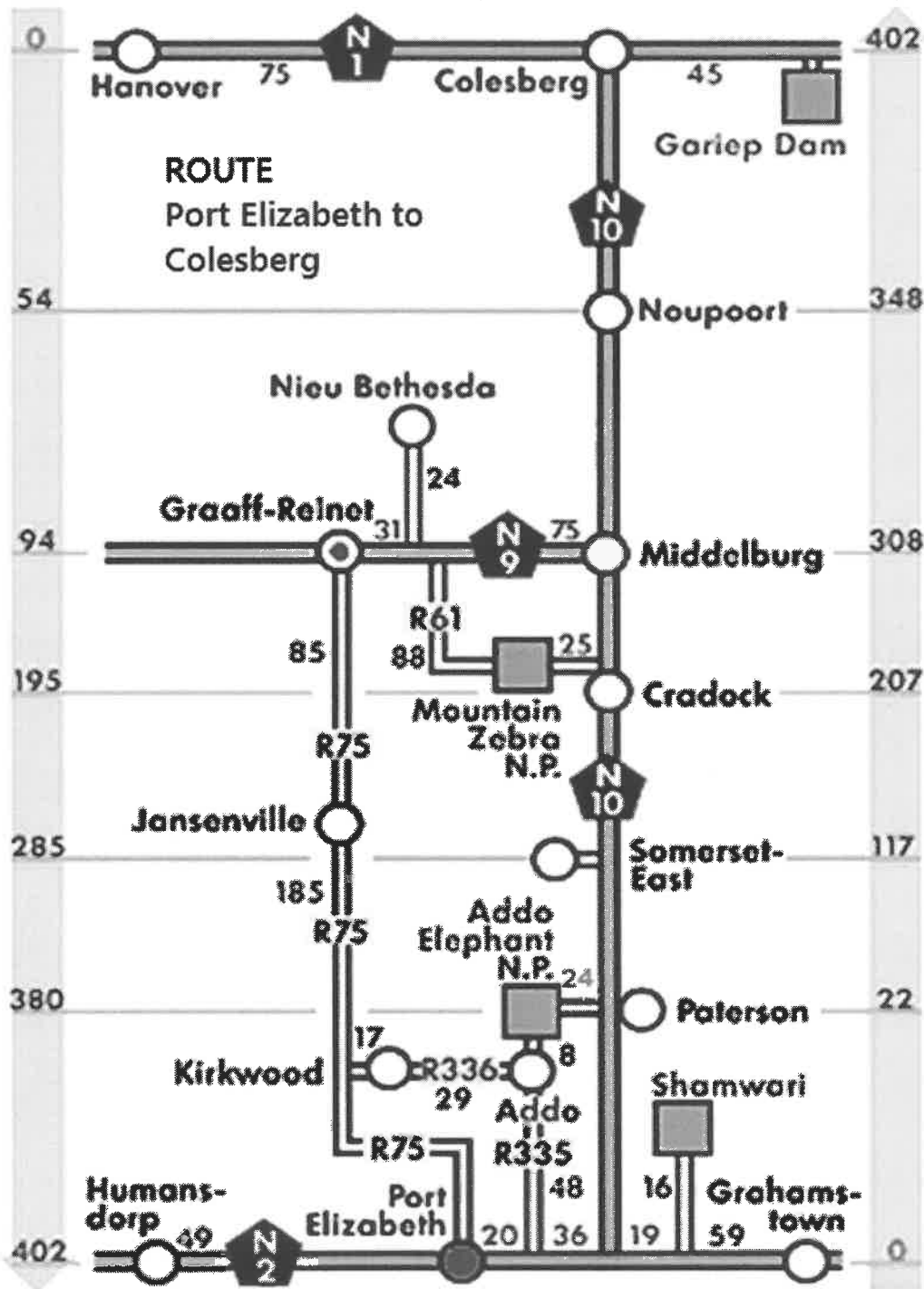

[Source: [www.google.com](http://www.google.com)]

KEY

	National road	N.P.	National Park
<b>R75</b>	Regional road		

**ANNEXURE C**

**QUESTION 4.2**

**FLOOR PLAN OF A HOUSE IN PORT ELIZABETH**

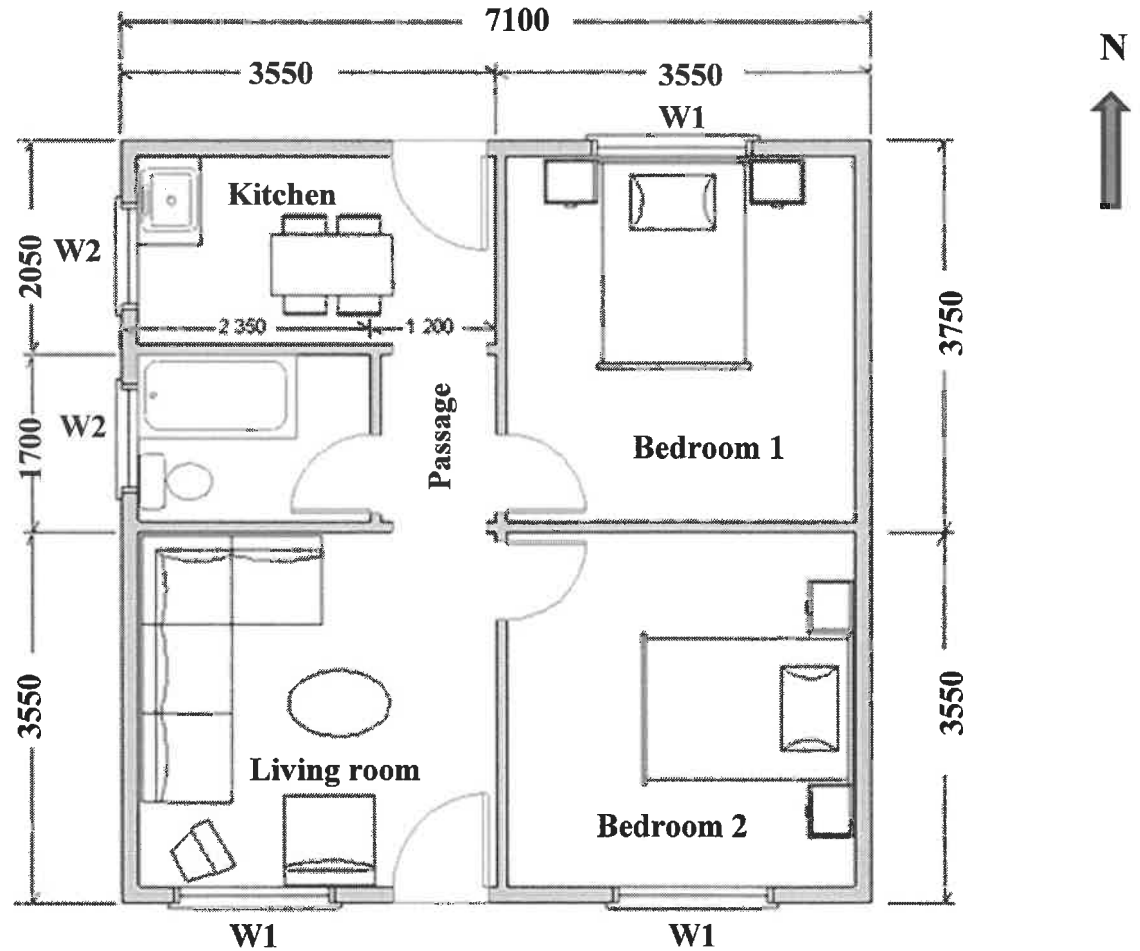

[Source: <http://www.saplans.co.zap1003>]

**NOTE:** All measurements are in **millimetres**.

KEY:	ITEMS	DESCRIPTION
	W1 =	Window opening
	W2 =	Window opening
		Opening requiring solid door