



basic education

Department:
Basic Education
REPUBLIC OF SOUTH AFRICA

**CONSUMER STUDIES
(PRODUCTION OF PATCHWORK AND
QUILTING ITEMS BY HAND)**

**GUIDELINES FOR
PRACTICAL ASSESSMENT TASKS**

2015

These guidelines consist of 18 pages.

THE PRACTICAL ASSESSMENT TASK FOR CONSUMER STUDIES PRODUCTION OF PATCHWORK AND QUILTING ITEMS BY HAND

1. INTRODUCTION

The 16 Curriculum and Assessment Policy Statement subjects which contain a practical component all include a practical assessment task (PAT). These subjects are:

- **AGRICULTURE:** Agricultural Management Practices, Agricultural Technology
- **ARTS:** Dance Studies, Design, Dramatic Arts, Music, Visual Arts
- **SCIENCES:** Computer Applications Technology, Information Technology
- **SERVICES:** Consumer Studies, Hospitality Studies, Tourism
- **TECHNOLOGY:** Civil Technology, Electrical Technology, Mechanical Technology and Engineering Graphics and Design

A practical assessment task (PAT) mark is a compulsory component of the final promotion mark for all candidates offering subjects that have a practical component and counts 25% (100 marks) of the end-of-year examination mark. The PAT is implemented across the first three terms of the school year. This is broken down into different phases or a series of smaller activities that make up the PAT. The PAT allows for learners to be assessed on a regular basis during the school year and it also allows for the assessment of skills that cannot be assessed in a written format, e.g. test or examination. It is therefore important that schools ensure that all learners complete the practical assessment tasks within the stipulated period to ensure that learners are resulted at the end of the school year. The planning and execution of the PAT differs from subject to subject.

- During the practical assessment task the learner must demonstrate his/her knowledge and practical ability/skills to produce patchwork and quilting items by hand focusing on suitability for selling.
- The practical assessment task for Consumer Studies Grade 12 consists of a layout and cutting session (part of practical examination 1) and two practical examinations of four hours each. Learners perform these practical examinations individually.
 - **Term 2: Practical examination 1 (plus layout and cutting session)**
Learners will make half of the item selected for the micro-enterprise used for the project in term 1.
 - **Term 3: Practical examination 2**
Learners will complete the item started in practical examination 1.

2. MARK ALLOCATION

- Each exam consists of 100 marks. The mark for the final practical assessment task is obtained by combining the marks for the two exams as indicated below:

Practical examination: term 2 (including layout and cutting)	100
Practical examination: term 3	100
Total	200 ÷ 2
Final mark for PAT	100

- The marks for the PAT are part of the end-of-the-year assessment.
- The province will provide two separate computerised mark sheets, one for SBA and one for the PAT. After the marks have been captured both mark sheets must be signed by the teacher, principal and moderator.

3. REQUIREMENTS FOR THE PRACTICAL EXAMINATIONS

Consumer Studies is a choice subject with five practical options. If the school chooses to offer Consumer Studies as a subject and selects the Patchwork and Quilting by Hand as practical option, the equipment and funds necessary to conduct the PAT, as well as the specified number of practical lessons is the responsibility of the school as specified in the CAPS document.

Ensure the following:

- A suitable classroom with the necessary equipment: tables for cutting out; two or more ironing boards and irons; cutting-out scissors (one for each learner); electricity, equipment for measuring and marking.
- A minimum of R30 to a maximum of R75 per learner for EACH of the two practical examinations is required, besides the funding required for the SBA practical lessons, to make the required items.
- A number of learners can do the examination simultaneously according to the number of work stations and resources available to complete the examination comfortably.
- Divide learners into groups of a maximum of 12 learners. Twenty-four learners (two groups of 12 learners) can perform the examination on the same day, e.g. from 08:00 to 12:00 and from 12:00 to 16:00.
- The teacher will need time between the two sessions to prepare the classroom for the second group.
- Schools with large numbers of learners will need more than one day to complete the examination.

4. REQUIRED TIMEFRAME

- Layout and cutting is done beforehand in a ONE-HOUR PERIOD under examination conditions.
- A timeframe of 4 HOURS in total is required per examination (excluding the one-hour layout and cutting session during practical examination 1).

5. SETTING THE EXAMINATIONS

5.1 Practical examination 1 (term 2)

- This practical examination **must be slotted into the examination timetable in the second term.**
- Learners will complete half of the item that has been selected for their micro-enterprise (project in term 1). The production process, workmanship and saleability of the products form an important aspect of the examination.
- The teacher must identify and select ONE suitable item for the micro-enterprise (project in term 1). The learners will make this item during practical examination 1 and practical examination 2.
- Teachers have TWO options when selecting the pattern for the practical examinations:
 - Buy a commercial pattern for an item that can be completed in 9 hours (PAT 1 plus 1 hour cutting out and PAT 2); **OR**
 - Use the same commercial pattern used in the practical lessons and remake the item once more in 9 hours (PAT 1 plus 1 hour cutting out and PAT 2).
- The item should carry a total weighting of 100 points on the skill-code list.

- The techniques to be completed per examination should have a total weighting of 50 points for each PAT task.
- Learners should start and complete half the item in practical examination 1.
- Learners must complete the one-hour layout and cutting session under examination conditions prior to practical examination 1.
- After four hours learners should hand in their items for assessment. After the assessment has been completed the items are returned to learners for correction and finishing off if necessary. The items will NOT be remarked after the corrections have been made.

5.2 Practical examination 2 (term 3)

- This examination will take place on a date agreed upon with the moderator.
- The learners will be assessed on the production process, workmanship and the saleability of the items.
- A timeframe of 4 hours in total is required per examination (excluding the one-hour layout and cutting session).
- The item selected will carry a total weighting of 100 points on the skills-code list.
- The techniques to be completed per examination should have a total weighting of 50 points for each PAT task.
- Learners must complete the second half of the item.
- After four hours learners should hand in their items for final assessment. After the assessment has been completed the items are returned to learners for correction and finishing off if necessary. The items will NOT be remarked after the corrections have been made.

6. PREPARING FOR THE EXAMINATION

The teacher is responsible for the following:

- Set the dates for both examinations. Communicate these dates to the SMT of the school to ensure that these dates do not clash with other school activities.
- Copy the pattern, illustration(s) and instruction sheet for each learner or buy a pattern for each learner. It is compulsory for each learner to work from an instruction sheet.
- Prepare the mark sheets provided with learners' names and their examination numbers.
- Learners must receive the pattern and instructions **one week (7 school days)** prior to the layout and cutting session, for preparation.
- Purchase the fabric and haberdashery, cut the fabric to the required size for each learner.
- Make up a 'kit' for each learner to include the following:
 - Fabric in the required size
 - The pattern and instruction sheet
 - The necessary haberdashery, such as buttons, lace, embroidery thread, pins, etc.
- Divide learners into groups according to the number of learners that can easily be accommodated in the room.
- Prepare the classroom and ensure the availability of the following:
 - Electrical power points and extension cords for all irons.
 - Irons and ironing boards
 - Large tables for the layout and cutting out of items
 - Enough small equipment, such as scissors, needles, quick-unpicks, pins, thread, bobbins and sharp scissors.

7. PERFORMING THE EXAMINATION

7.1 Practical examination 1 in term 2: 5 hours

7.1.1 The layout and cutting-out session: 1 hour (prior to the day of practical examination 1)

- Hand out each learner's 'kit', including the fabric, pattern instruction sheet and haberdashery, such as the lace.
- The teacher is NOT allowed to assist the learner at all during the cutting session.
- During the cutting session the teacher allocates marks.
- Learners may improve/correct the cut-out pattern pieces or cut out new pieces after the cutting session is over and marks have been allocated, but this will NOT be remarked.
- The teacher then keeps all the learners' pattern pieces in a safe place until the day of practical examination 1.

7.1.2 Practical examination 1 in term 3: 4 hours

- When the learners enter the classroom hand them their 'kits' with the cut-out pattern pieces and extra scraps of material.
- Enough scissors, pins and needles should be available.
- Individual learners, under the supervision of the teacher, carry out practical examination 1.
- The products should be ready for assessment after 4 hours.
- Learners will lose **2 marks for every 5 minutes late** up to a maximum of 20 marks.
- Only the teacher, the moderator and the candidates may be in the room during the practical examination.
- The teacher must invigilate and assess the learners while they are performing the practical examination and he/she may not do any other work or assist the learners in any way.
- The teacher must mark practical examination 1 and capture the marks. Then the learners may correct mistakes, make improvements and complete the item. The item will NOT be remarked after the corrections have been made.
- After the corrections have been made the item goes back into the 'kit', to be kept in a safe place until the day of practical examination 2.

7.2 Practical examination 2 in term 3: 4 hours

- When learners enter the classroom hand them their 'kits' with the half completed items and extra scraps of material.
- Enough scissors, pins and needles should be available.
- Individual learners, under the supervision of the teacher, carry out practical examination 2.
- The products should be ready for assessment after 4 hours. Learners will lose **2 marks for every 5 minutes late** up to a maximum of 20 marks.
- Only the teacher, the moderator and the candidates may be in the room during the practical examination.
- The teacher must invigilate and assess the learners while they are performing the practical examination and he/she may not do any other work or assist the learners in any way.
- The teacher must mark practical examination 2 and capture the marks. Then the learners can correct mistakes, make improvements and complete the item. The item will NOT be remarked after the corrections have been made.
- After the corrections have been made the items are kept in a safe space until the day of moderation.

8. EVALUATION

- The teacher and moderator have 30 minutes to evaluate the final products, inspect the learners' work stations and complete the mark sheets.
- The learners should tidy up their work stations on completion of the examination so that the teacher can inspect the work stations for the final allocation of marks.

9. MODERATION OF THE PRACTICAL EXAMINATION

9.1 BEFORE practical examination 1

The subject advisor must receive the following before the end of term 1 for moderation to ensure the examination is of an appropriate standard:

- A photocopy of the pattern envelope
- An illustration of the item
- The list of fabrics, haberdashery, etc. to be purchased
- The estimated cost per learner
- The completed checklist, checked and signed by the principal
- An instruction page for the learners with the assessment criteria and mark allocation for both practical examination sessions
- Mark sheets for each practical examination
- Planning for all three sessions (layout and cutting, practical examination 1 and practical examination 2) indicating the total weighting of techniques

The PAT cannot be done unless it was approved by the subject advisor.

9.2 ON THE DAY of practical examination 2

- During term 3 the last group of a maximum of 12 learners will be externally moderated by the subject advisor while performing the practical examination at the school.
- The teacher must have the following available for the moderator on the day of moderation:
 - All the items that learners made during practical classes for SBA (if not moderated during SBA moderation)
 - A copy of the completed recording sheet for practical lessons
 - The completed items (marked) of all the learners who have already completed the examination
 - The marks of all learners who have completed the examination already
 - A separate set of assessment tools for the moderator to use, with the names and examination numbers of the learners already on the mark sheet
- The moderator will randomly select six candidates and independently assess the learners while they are performing the examination as well as the items produced by the selected learners.
- Afterwards the moderator will compare his/her assessment with that of the teacher. If the moderator finds that the marks of the teacher differ more than 10% from his/her marks, a block adjustment upwards or downwards should be made based on the difference.
- The computerised mark sheet must be completed on the day of moderation.

- The table below demonstrates how to determine the difference between the moderator's marks and teacher's marks to determine if adjustment is needed and the margin of adjustment required:

				PAT 2	
				100	
Learner Name				*T	*M
Learner A				84	69
Learner B				83	70
Learner C				68	53
Learner D				59	44
Learner E				49	40
Learner F				45	40
TOTAL				388	316
AVERAGE MARK = TOTAL ÷ 6 (number of learners)				66	53
DIFFERENCE = 66 (*T) – 53 (*M)				13	
ADJUSTMENT	DOWNWARDS	<input checked="" type="checkbox"/>	UPWARDS	– 3	

***T- Teacher; *M = Moderator**

- A block adjustment can also be made based on the professional judgement of the moderator if the practical exam of the school is not of the expected standard.
- The moderator will discuss the outcome and any adjustments with the teacher. The final moderated marks should then be entered on the computerised mark sheet.
- The marks of all learners will be affected if an adjustment is made.
- The marks of all the learners need to be finalised and signed by the subject advisor and principal on the day of this examination. The computerised mark sheet must be completed on the day of moderation.

SKILL-CODE WEIGHTING FOR TECHNIQUES USED FOR PATCHWORK AND QUILTING PRODUCTION BY HAND

- Use the following skill-code weighting to choose a pattern for the PAT as well as for the weekly practical lessons.
- The skills code indicates the weighting for the techniques and NOT the mark allocation.
- The weighting for a specific technique should only be allocated ONCE.
- The teacher could add a technique not listed below after discussing it with the subject advisor. The teacher and subject advisor should then decide on the weighting for the new technique.

Choice of fabric (Teacher should have box of fabric from which learners can choose) <ul style="list-style-type: none"> • Matching fabric types (100% cotton) • Fabric choice for easy wash and care • Successful choice of colours 	10 3 3 4	Quilting <ul style="list-style-type: none"> • Sandwiching/Tacking top layer, batting and lining • Baste the three layers • Transfer of quilting design • Even and neat quilting stitches • Stitching straight/smooth curves/square corners • Choice of quilting thread 	20 2 4 4 4 4 2
Patchwork design <ul style="list-style-type: none"> • Templates placed correctly and economically on the fabric • Patchwork pattern designed on paper • Design matches the choice of fabric and item • Level of difficulty (number and shape of patches; Refer to CAPS for techniques per grade) 	10 2 2 3 3	Seams and seam finishing (<i>assemble item, e.g. bag</i>) <ul style="list-style-type: none"> • Straight seams with finish • Stitching straight/smooth curves/square corners • Seam allowance correct and even width • Seam finishing 	10 3 2 3 2
Design, layout and cutting of pattern pieces (<i>Patchwork pieces, lining and batting included</i>) Patchwork: <ul style="list-style-type: none"> • Measure and cutting fabric patches accurately • Size of fabric pieces suitable for size of item • Correct number of patchwork pieces Other pattern pieces: <ul style="list-style-type: none"> • Pattern pieces placed economically on fabric • Lining and batting pattern pieces measured and marked on fabric accurately • Straight cutting 	20 4 3 5 2 4 2	Edge finish/Crossway binding <ul style="list-style-type: none"> • Cut and join crossway strips for crossway binding/ Cut straight binding accurately to measurements/ pattern • Attach binding for edge finishing <ul style="list-style-type: none"> ○ Correct and even width ○ Lies flat and even • Neatly stitched 	15 5 3 2 2 3
Seams/Joining of patchwork pieces <ul style="list-style-type: none"> • Patches joined according to design • Small even stitches by hand • Straight seams/smooth curves/square corners • Seam allowance = 0,5 cm • Alignment of patches/Final appearance • Correct ironing of seams 	20 3 4 3 3 4 3	Stitched-on pocket <ul style="list-style-type: none"> • Pocket shape, size, hem • Place on item (correct position) • Stitching to attach pocket to item 	10 4 3 3
Embroidery: 3–5 decorative stitches by hand <ul style="list-style-type: none"> • Good design, suited for item • Good choice of colours • Techniques for embroidery stitches 	10 2 3 5	Bands (handles for bags) <ul style="list-style-type: none"> • Even width, suitable for bag • Reinforced inside with suitable fabric • Attached to bag and reinforced on bag 	10 2 3 5
Decorating other than embroidery <ul style="list-style-type: none"> • Use of other embellishments e.g. lace, beads, buttons, etc. 	5	Attaching fasteners <ul style="list-style-type: none"> • Such as Velcro/button & loop/press stud, etc. 	5
Cutting of lining and batting <ul style="list-style-type: none"> • Suitable fabric choice • Correct size/shape 	8 4 4	Ironing: <ul style="list-style-type: none"> • Continuous, correct ironing during construction • Final press 	5 3 2
Attaching the lining <ul style="list-style-type: none"> • Seam allowance 0,5 cm • Straight seams • Neatly attached to the bag • Correct size 	15 3 4 4 4		

TEACHER PLANNING
GRADE 12 PRACTICAL ASSESSMENT TASKS 1 AND 2

(To be submitted to the subject advisor for moderation at the end of term 1 or earlier.)

Name of school:
Name of teacher:
Date and time of examination sessions:

TESTS FOR PAT GRADE 12
(Attach copies of patterns and instruction sheets)

LAYOUT AND CUTTING	
TECHNIQUES	WEIGHTING
TOTAL	

PRACTICAL EXAMINATION 1 IN TERM 2	
TECHNIQUES	WEIGHTING
TOTAL	

PRACTICAL EXAMINATION 2 IN TERM 3	
TECHNIQUES	WEIGHTING
TOTAL	

EXAMPLE OF TEACHER PLANNING FOR PURCHASES

(To be submitted to the subject advisor for moderation at the end of term 1 or earlier)

Total number of learners	Groups	Number of learners per group	Dates	Time
25	1	8	10/09/2015	08:00–13:00
	2	8	10/09/2015	12:30–17:30
	3	9	11/09/2015	08:00–13:00

Exam	Requirements per learner	Quantity required per learner	Number of learners	Total
1	100% cotton (30 cm x 3)	90 cm	25	22,5 metres
	Sewing thread	1 reel		25 reels
	Pattern	1		25 patterns
	Batting	1 m		25 metres
	Fusible interfacing	20 cm		5 metres
	Thread for basting	1		25 reels
	Quilting thread	1 reel		25 reels
	Lace/braid	50 cm		12,5 metres

TEACHER'S SHOPPING LIST

Requirements	Amount	Approximate cost
100% cotton	22,5 metres	
Sewing thread	25 reels	
Pattern	25 patterns	
Batting	25 metres	
Fusible interfacing	5 metres	
Thread for basting	25 reels	
Quilting thread	25 reels	
Lace/Braid	12,5 metres	

Approximate cost of shopping list:

ESTIMATED COST PER LEARNER:

TEACHER PLANNING FOR PURCHASES

(To be submitted to the subject advisor for moderation at the end of term 1 or earlier)

Total number of learners	Groups	Number of learners per group	Dates	Time

Exam 1	Requirements per learner	Quantity required per learner	Number of learners	Total

Exam 2	Requirements per learner	Quantity required per learner	Number of learners	Total

TEACHER'S SHOPPING LIST

Requirements	Amount	Approximate cost

Approximate cost of shopping list:

ESTIMATED COST PER LEARNER:

MARK SHEET FOR PATCHWORK AND QUILTING – PRACTICAL ASSESSMENT TASK

PAT 1													
SCHOOL		NAMES OF LEARNERS											
		1	2	3	4	5	6	7	8	9	10	11	12
DATE													
EXAMINER													
1	PRACTICAL SKILLS AND TECHNIQUES	15											
	Layout, cutting	4											
	Measure and cut fabric patches accurately	4											
	Correct number of patchwork pieces	1											
	Pattern pieces placed economically on fabric	2											
	Lining and batting pattern pieces measured and accurately marked on fabric	2											
	Straight cutting	1											
	Pattern interpretation	5											
	Follow pattern instructions	5											
	Use of equipment	5											
Correct handling of small equipment, e.g. tape measure, scissors, needles, etc.	2												
Correct handling of large equipment, e.g. iron, etc. (<i>Machines correctly threaded and used, safe and correct use of equipment.</i>)	3												
Order of work and efficient use of time	5												
Ability to follow order of instructions	3												
Efficient use of time	2												
2	NEATNESS AND ECONOMIC USE OF RESOURCES												
	Organisation of work station and equipment	5											
	Work station well organised	2											
	Small equipment not lying around	1											
	Handling of equipment after use, correct handling of off-cuts and waste (<i>Teacher observes each learner regularly during the exam, to determine the final mark.</i>)	2											
	Personal appearance	5											
	Appropriately dressed (school uniform, clean hands)	5											
	Neatness of work station on completion of examination	5											
Equipment unplugged, cleaned and stored securely	2												
Electrical power points switched off	2												
Work area neat and clean	1												
3	SUITABILITY FOR SELLING												
	General appearance	20											
	Neatness of item	10											
	Prescribed techniques completed	10											
	Workmanship	40											
	Stitching	10											
Construction	20												
Finishing	10												
TOTAL	100												

MARK SHEET FOR PATCHWORK AND QUILTING – PRACTICAL ASSESSMENT TASK

			PAT 2														
SCHOOL			NAMES OF LEARNERS														
			1	2	3	4	5	6	7	8	9	10	11	12			
DATE																	
EXAMINER																	
1	PRACTICAL SKILLS AND TECHNIQUES																
	Pattern interpretation	10															
	Follow pattern instructions																
	Use of equipment	5															
	Correct handling of small equipment, e.g. tape measure, scissors, needles, etc.	2															
	Correct handling of large equipment, e.g. iron, etc. <i>(Machines correctly threaded and used, safe and correct use of equipment.)</i>	3															
	Order of work and efficient use of time	5															
	Follow instructions in a logical way/correct sequence	3															
	Efficient use of time	2															
2	NEATNESS AND ECONOMIC USE OF RESOURCES																
	Organisation work station and equipment	5															
	Work station well organised	2															
	Small equipment not lying around	1															
	Handling of equipment after use, correct handling of off-cuts and waste. <i>(Teacher observes each learner regularly during the exam to determine the final mark.)</i>	2															
	Personal appearance	5															
	Appropriately dressed (school uniform, clean hands)																
Neatness of work station on completion of exam	5																
Electrical equipment unplugged, cleaned and stored securely	2																
Electrical power points switched off	2																
Work area neat and clean	1																
3	SUITABILITY FOR SELLING:																
	General appearance	20															
	Neatness of item and finishing	10															
	Prescribed techniques completed	10															
	Workmanship	40															
	Stitching	10															
Construction	20																
Finishing	10																
TOTAL	100																

**CONSUMER STUDIES PATCHWORK AND QUILTING BY HAND
PRACTICAL ASSESSMENT TASK
CHECKLIST FOR PLANNING TO BE HANDED IN FOR MODERATION**

SCHOOL		
TEACHER		
PRINCIPAL		
DATE SUBMITTED		
Dates of all PAT sessions	Proposed moderation date	Approved moderation date

CRITERIA	YES/NO	COMMENTS BY MODERATOR
Items included for PAT 1 and 2		
An illustration of the item/ photo copy of the pattern envelope		
Copy of the pattern instruction sheet to be provided to learners		
Completed techniques and total weighting of item for PAT 1		
List of purchases		
Estimated cost per learner		

APPROVED/NOT APPROVED

RESUBMISSION DATE: _____

Signatures:

TEACHER: _____

DATE: _____

PRINCIPAL: _____

DATE: _____

MODERATOR: _____

DATE: _____

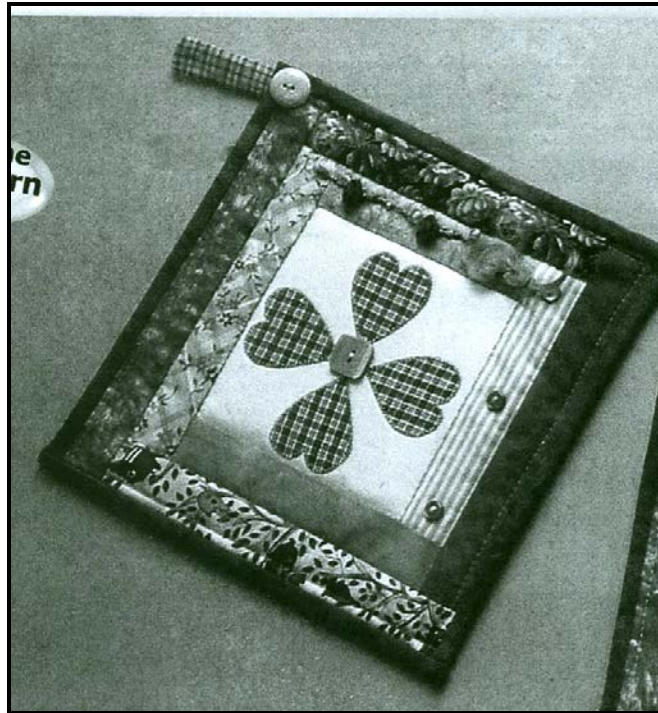
EXAMPLE OF ITEM FOR PRACTICAL ASSESSMENT TASK**LITTLE HEART QUILT****WEIGHTING:**

LAYOUT AND CUTTING PRACTICAL EXAM 2	
TECHNIQUES	WEIGHTING
Design, layout and cutting of pattern pieces	20
Choice of fabric	10
Embroidery	10
Seams	20
Embellishments, e.g. lace	5
Quilting	20
Edge finishing/binding	15
TOTAL:	100

The above can be repeated for PAT 2 and the squares are attached to each other with a button on one corner.

REQUIREMENTS:

- 1 x 12,5 cm calico square
- Off-cuts of different fabrics for hearts
- 30 x 40 cm appliqué paper
- 10 x 50 cm pieces of fabric in light, medium and dark colours for the strips (eight to ten different patterns)
- 20 x 20 cm piece of dark fabric for binding
- 25 x 25 cm batting
- 25 x 25 cm backing
- Embellishments: bought ribbon roses, buttons, beads, yarn
- Embroidery thread to match fabrics/hearts
- Pencil and scissors
- Embroidery needle, quilting needle and neutral quilting thread
- Rotary cutters, mat and ruler (if possible)

THE LAYOUT AND CUTTING OUT SESSION: 1 hour (a day prior to PAT 1)

- The learner must receive a 'kit' including the fabric, pattern instruction sheet and haberdashery, such as the lace, buttons, etc. He/She must select the fabric he/she would like to use for the item.
- During this one-hour session they will be required to cut out the pattern pieces, batting and lining.
- Transfer pattern markings where applicable.
- Submit to teacher for marking.
- Learners may improve/correct the cut-out pieces if necessary, after the cutting session is over, but NO remarking will be done.
- The pattern pieces must be submitted to the teacher for safe keeping until the day of PAT 1.

PAT 1 SESSION: 4 hours

PATTERN INSTRUCTION SHEET

Layout and cutting session:

1. Copy the hearts from the pattern sheet onto appliqué paper and cut out. Cut a 12,5 cm square from the appliqué paper as well as fabric of your choice.
2. Cut 3,5 cm strips from 8 different light, medium and dark fabrics.
3. Cut four strips, 5 cm wide and 19 cm long, from one of the darkest fabrics.
4. Cut one 18 cm square of batting and backing fabric each.
5. Fuse the heart(s) onto the calico square with the fusible interfacing.

Practical examination sessions 1 and 2:

1. Blanket stitch around the heart(s) with matching embroidery thread.
2. When complete, fuse the remaining appliqué paper square onto the back of the calico square to create a firm surface for attaching the beadwork/embellishments.
3. Decorate the hearts any way you like.
4. Sew the first strip (lightest) by hand onto the calico square. Press and trim.
5. Sew the next strip by hand onto the next side of the calico square. Press and trim back.
6. Continue adding strips onto the calico square finishing with the darkest strips on the outside. See diagram below.

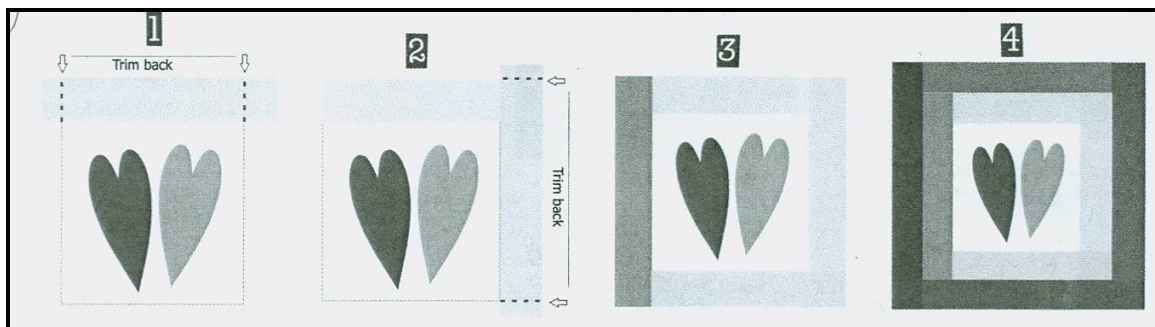

7. Trim the blocks square, add embellishments onto some of the strips.
8. Place the backing fabric right side down on the work surface. Then place the batting on top and finally the completed block.
9. Pin and tack together.
10. Quilt along all the seam lines.
11. Fold the strip in half lengthwise (wrong sides facing) and press. Place the raw edge of the strip against the raw edge of the block (on the right side) and sew in place.
12. Fold the strip over to the back of the block and hand stitch in place. Trim off excess on ends.
13. Do the same on the opposite side.
14. Attach the binding to the top and bottom of the block, allowing an extra 1 cm at each end. Turn the ends in neatly and fold over to the back of the block, hand stitch in place.

TEMPLATES

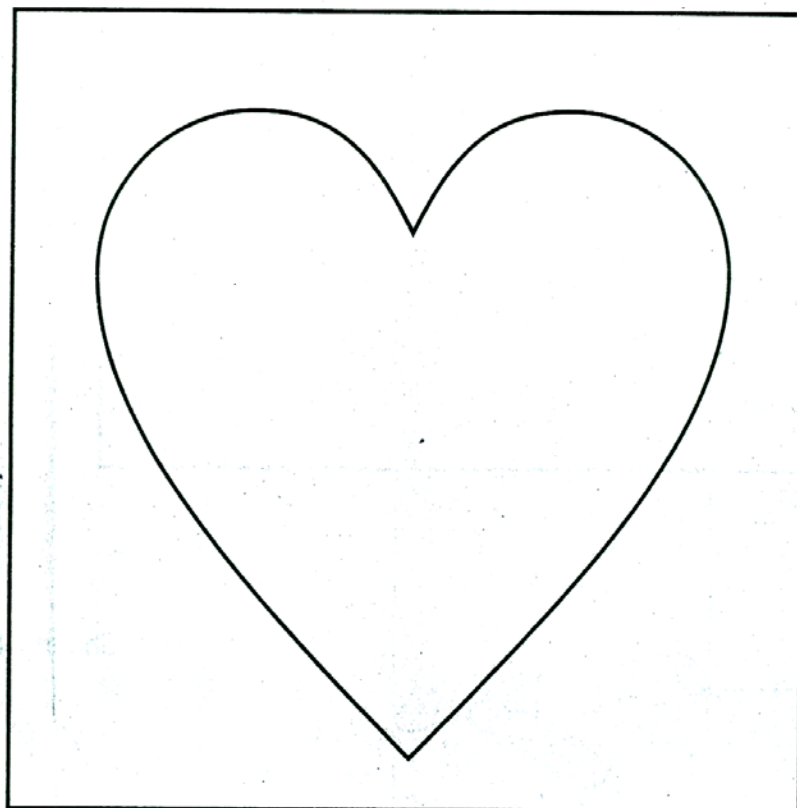
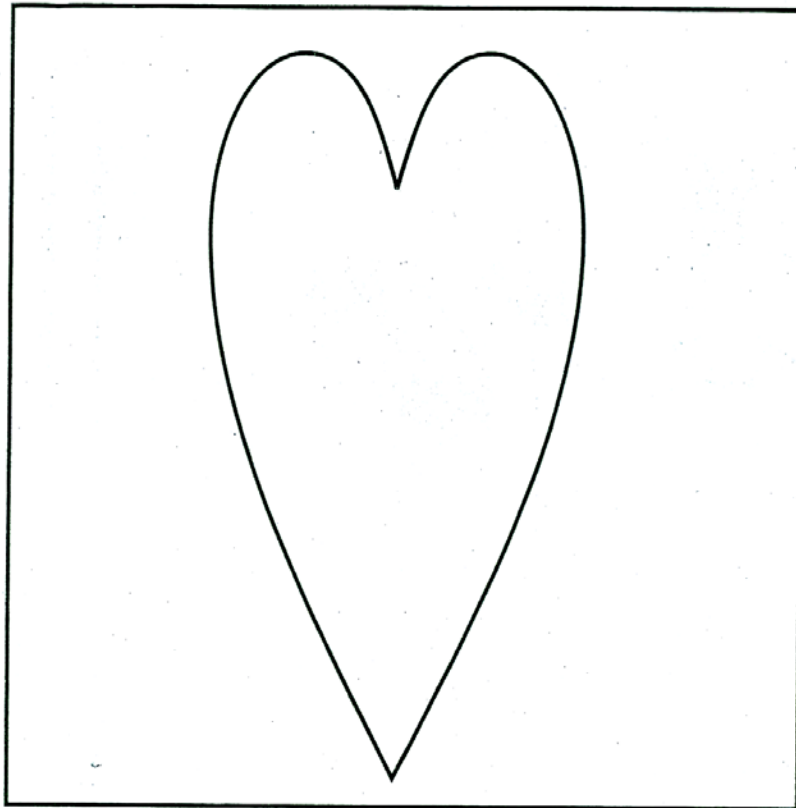

NSC (Production of Patchwork Quilting Hand)

